

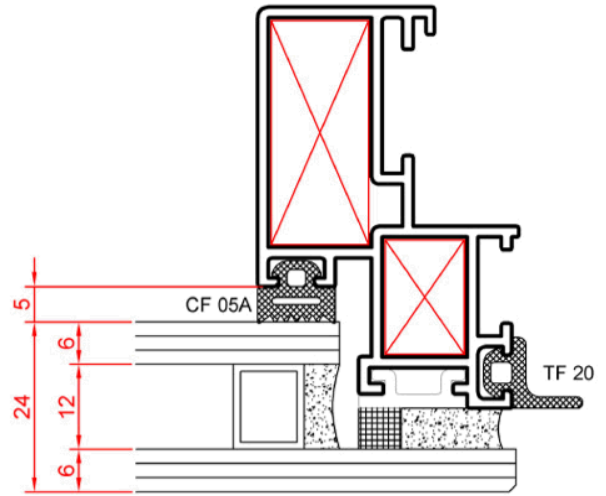

5062 NO'LU PROFİLE GÖRE

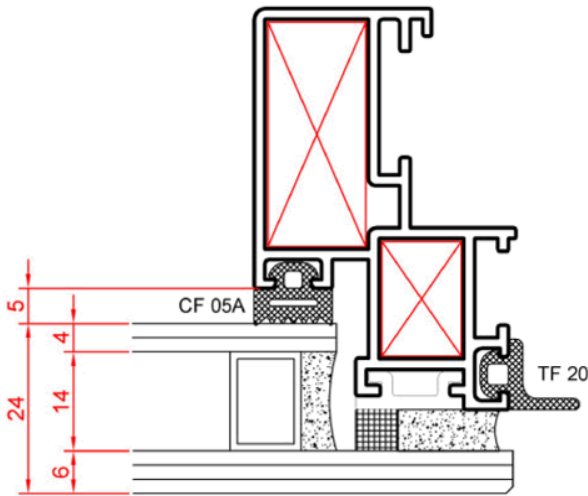

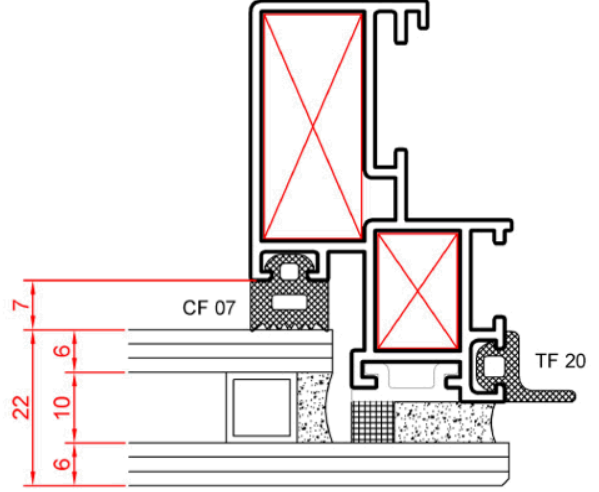
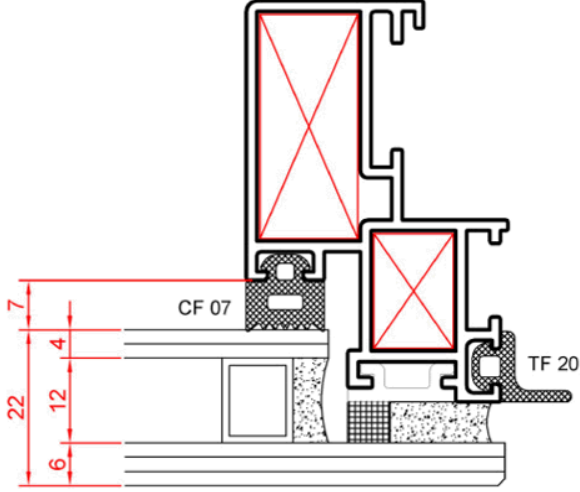

5028 NO'LU PROFİLE GÖRE

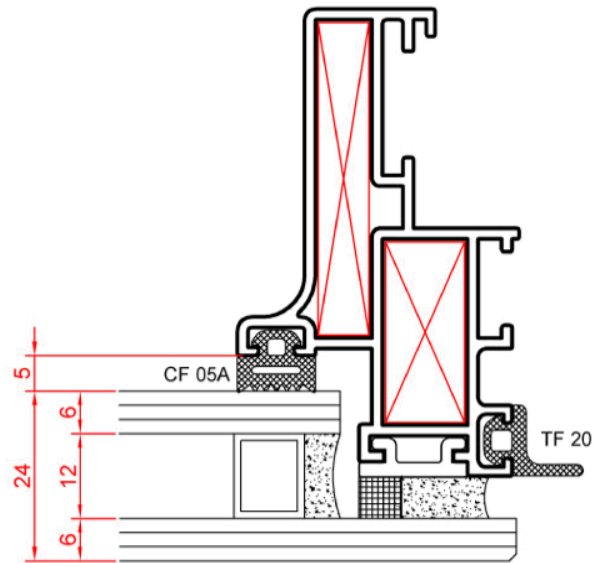
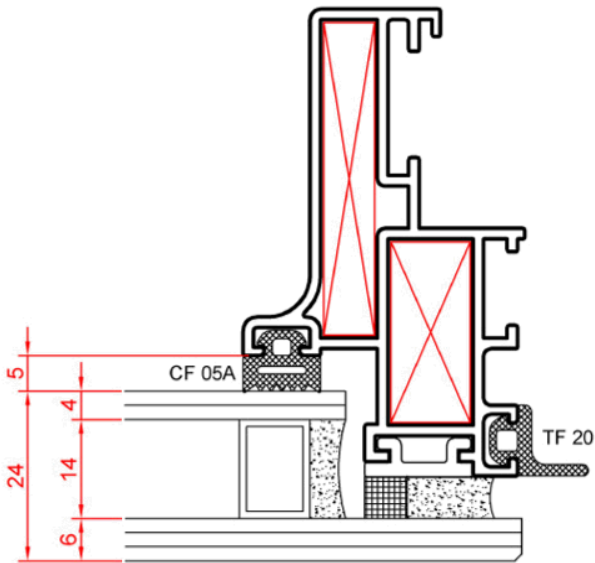
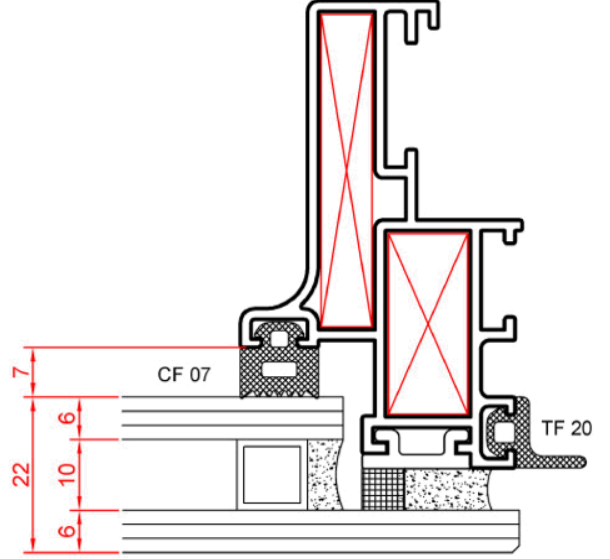
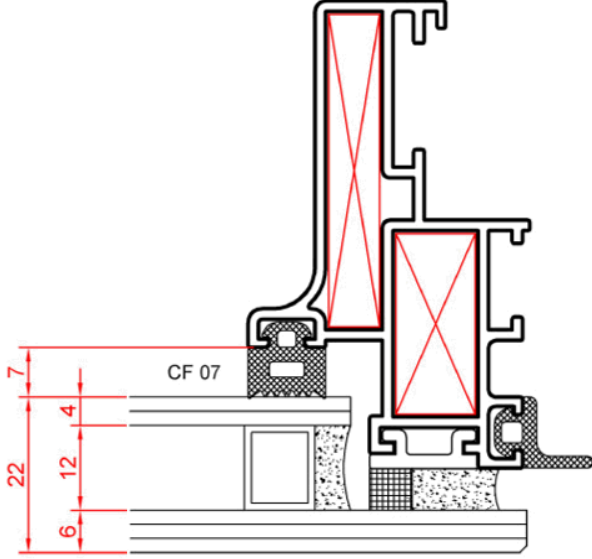



**KIRLANGIÇ GEÇMEYE GÖRE**

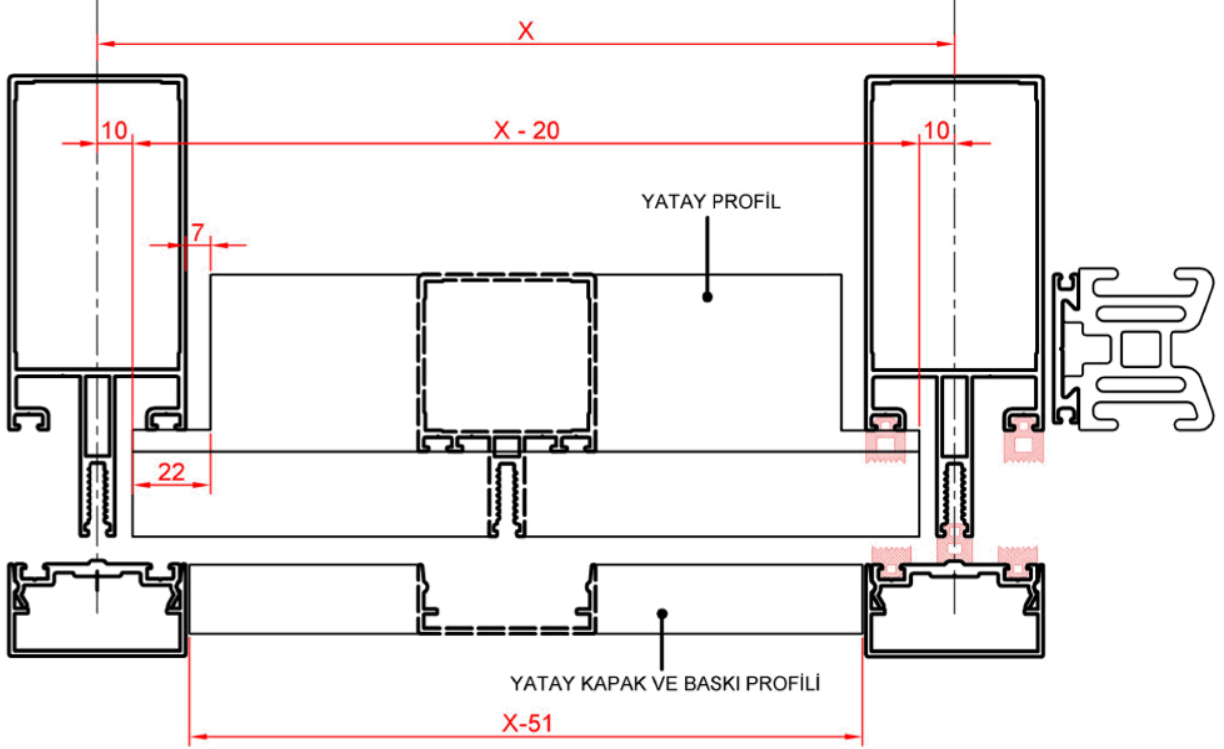

**DÜZ GEÇMEYE GÖRE**

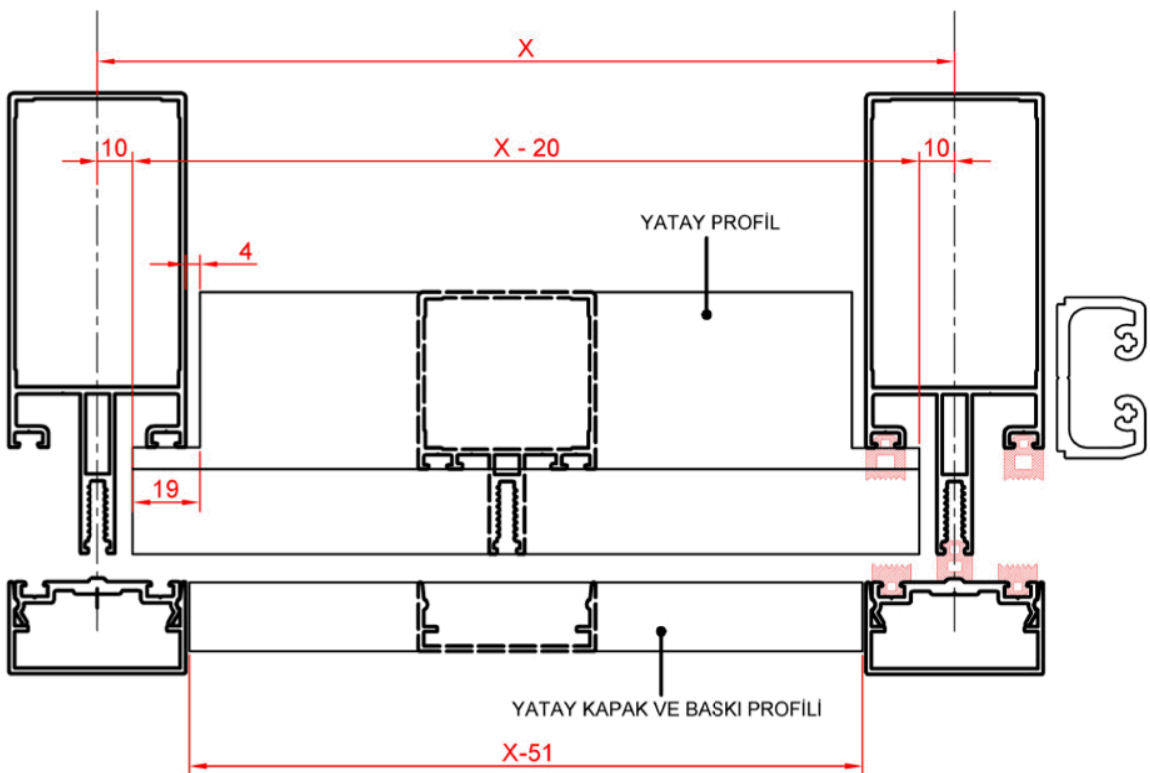

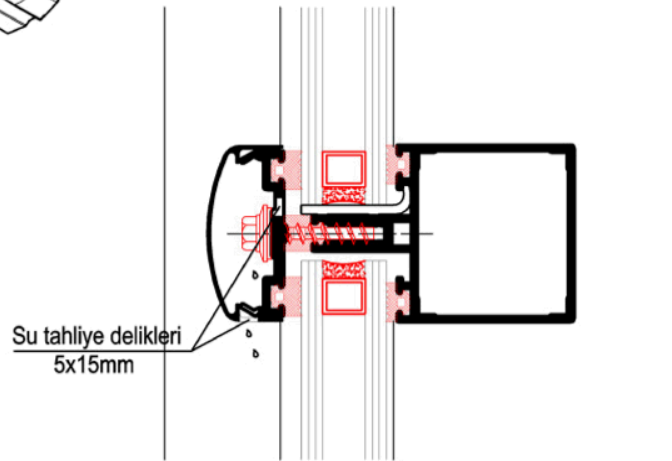
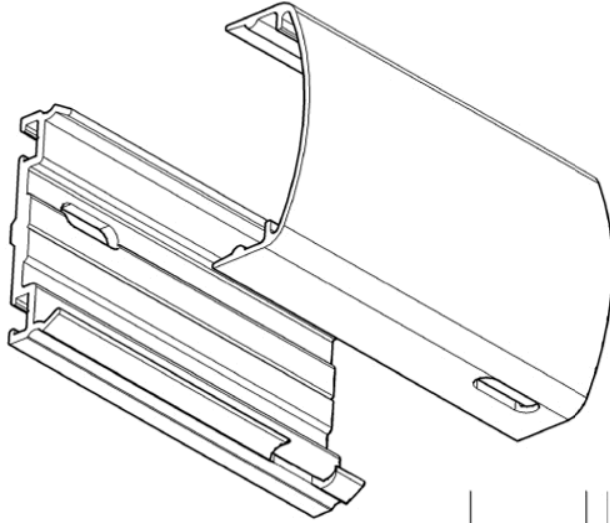
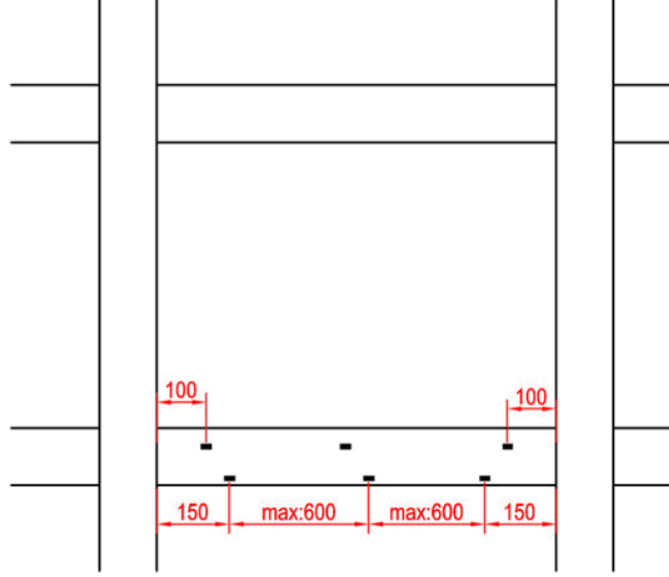

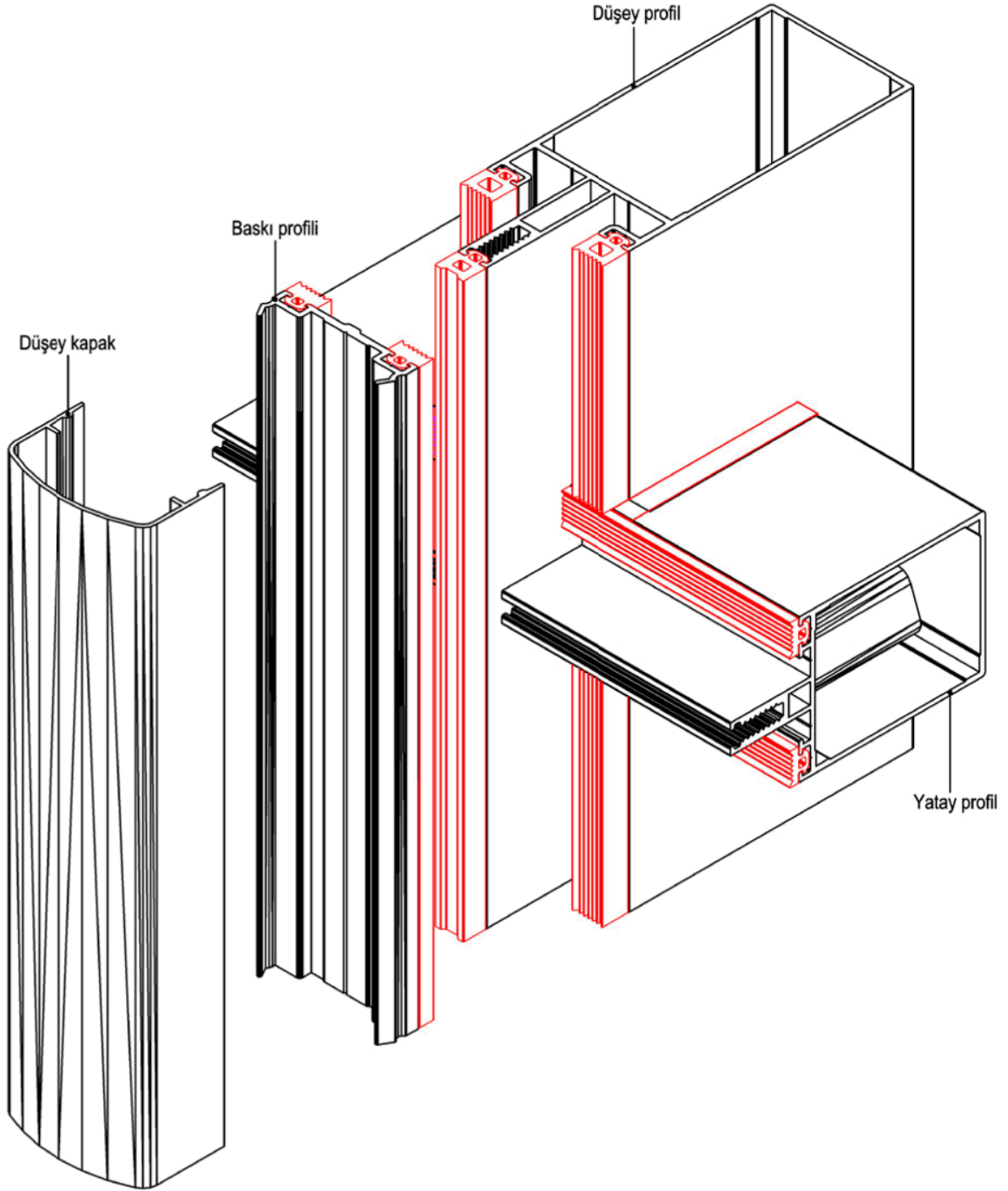



**KASET KESİMİ**

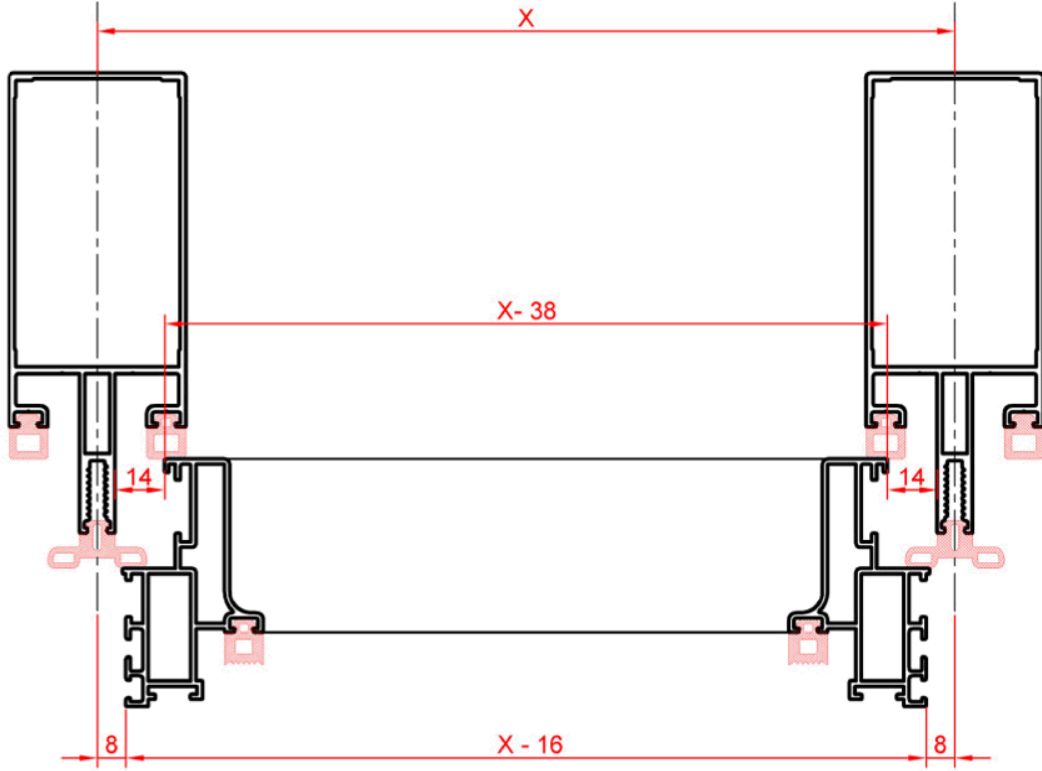

**CAM YAPIŞTIRMA PROFİLİ KESİMİ**

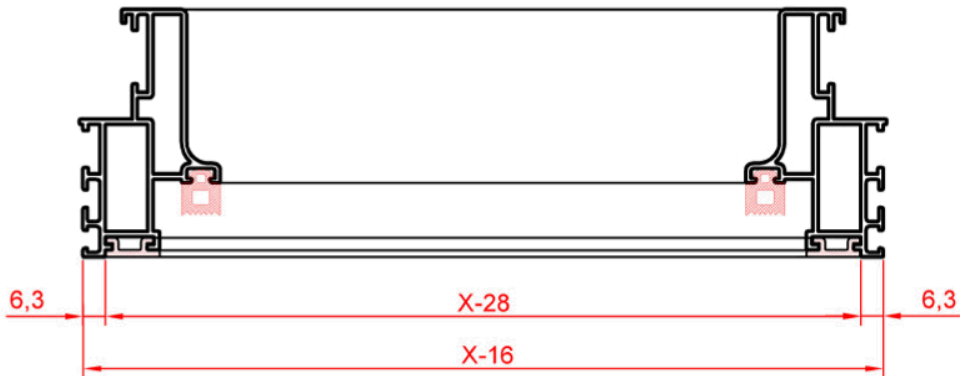

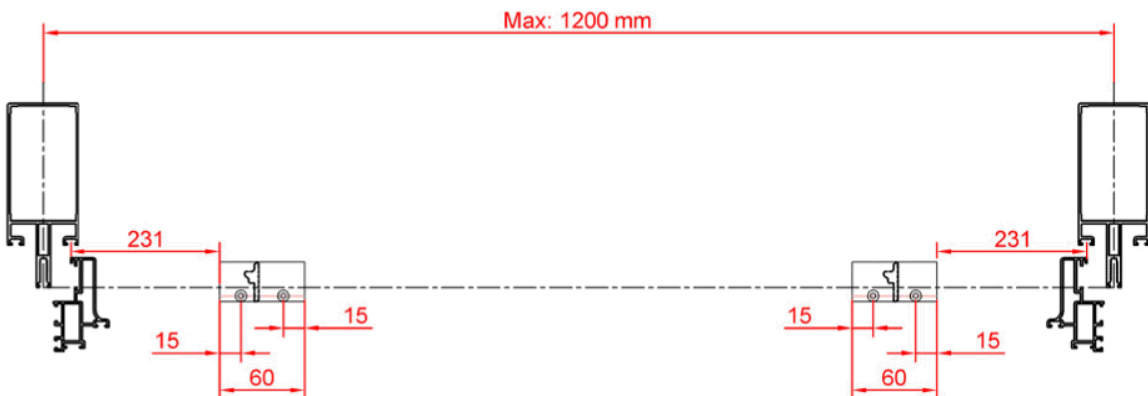
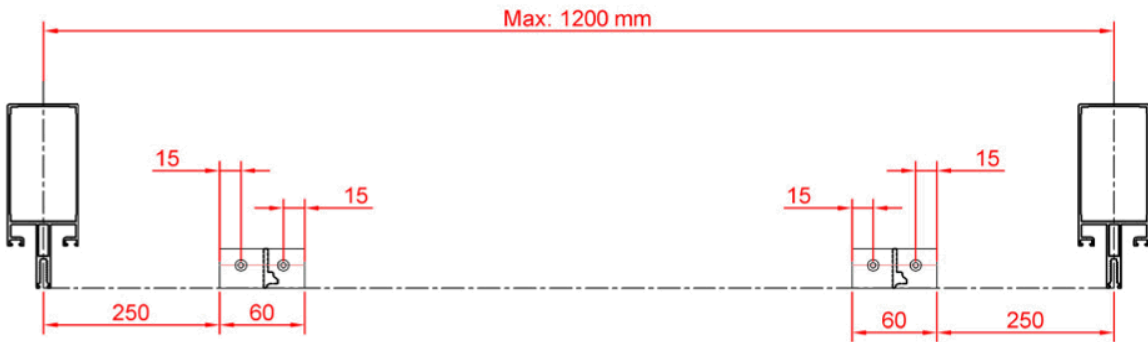
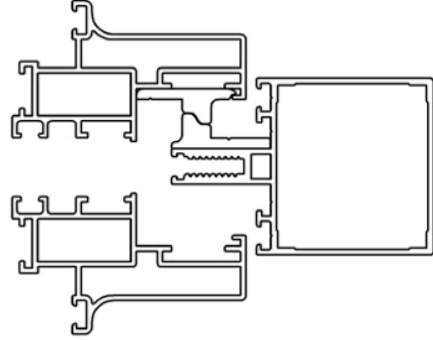
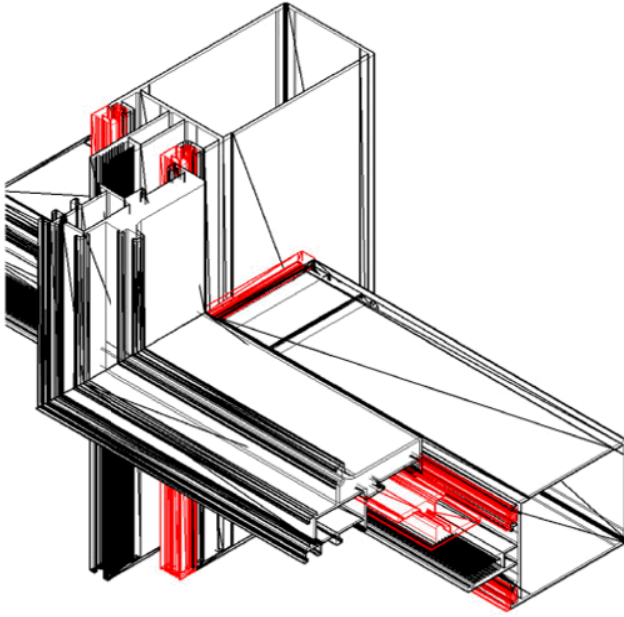



**AKPA®**  
ALÜMİNYUM PLASTİK  
SAN. VE TİC. LTD. ŞTİ.

## SİLİKON CEPHE SİSTEMİ

### YAN KİLİT DETAYI

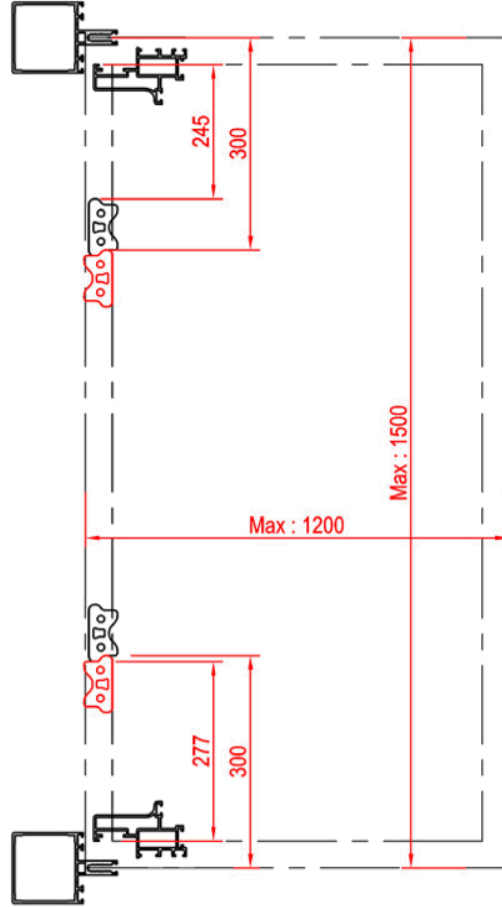
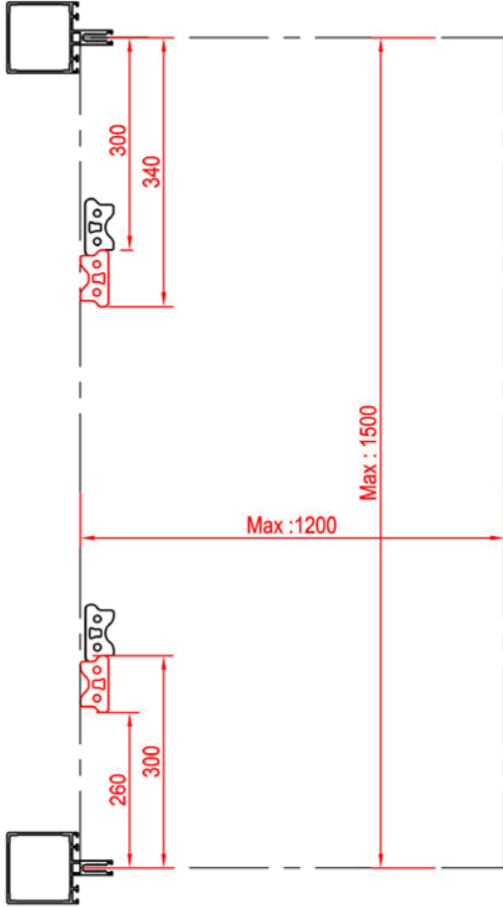
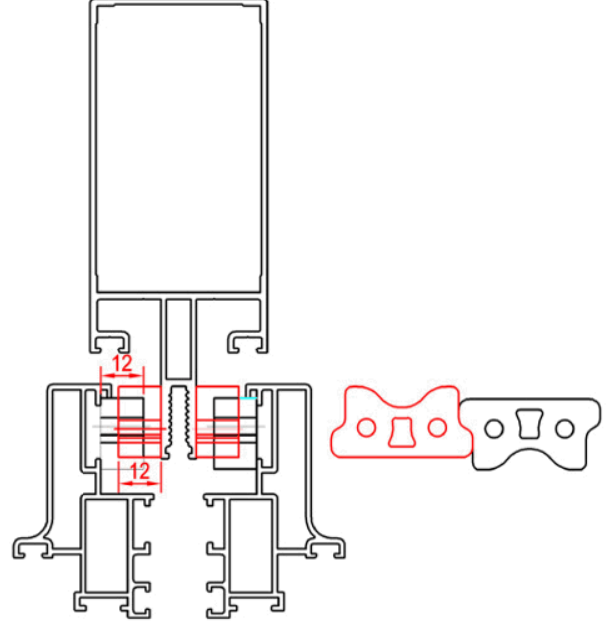
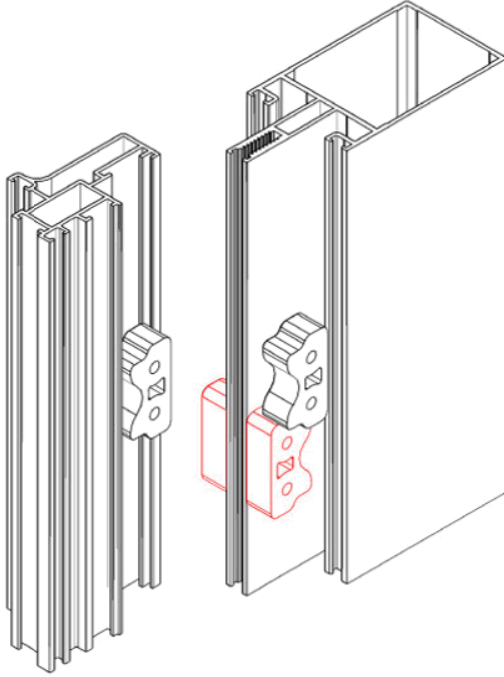

Not: Kaset yüksekliği 1500 mm geçtiği durumlarda min: 400 mm ara ile 5024 bağlantı profili kullanılmalıdır.





**AKPA®**  
ALÜMİNYUM PLASTİK  
SAN. VE TİC. LTD. ŞTİ.

## SİLİKON CEPHE SİSTEMİ

### KASET TESPİT DETAYI

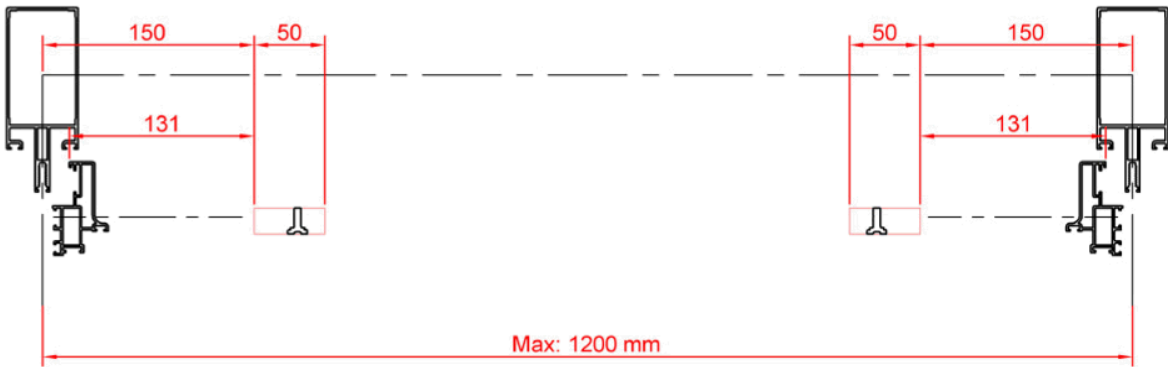
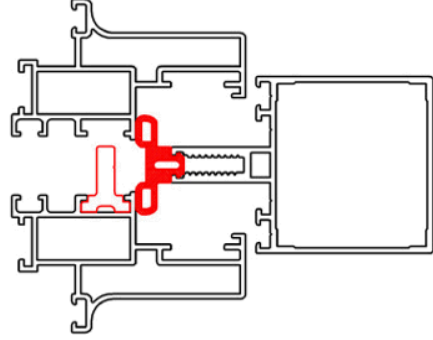
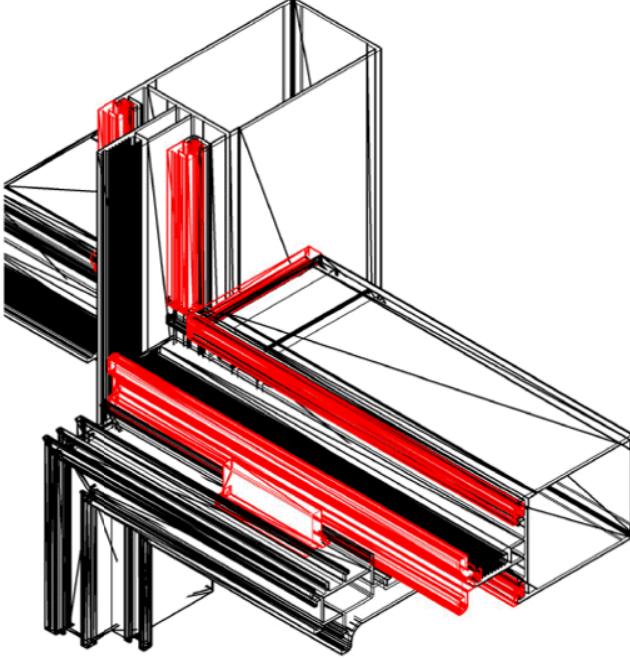



**AKPA**<sup>®</sup>  
ALÜMİNYUM PLASTİK  
SAN. VE TİC. LTD. ŞTİ.

## KAPAKLI VE SİLİKON CEPHE SİSTEMİ DERZ PROFİLİ MONTAJ DETAYI

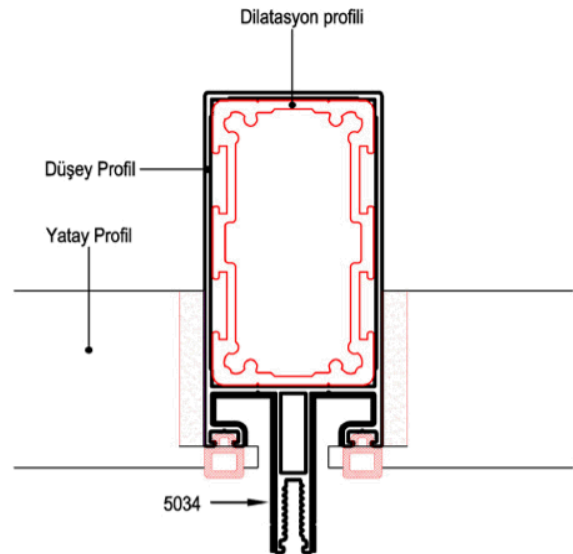
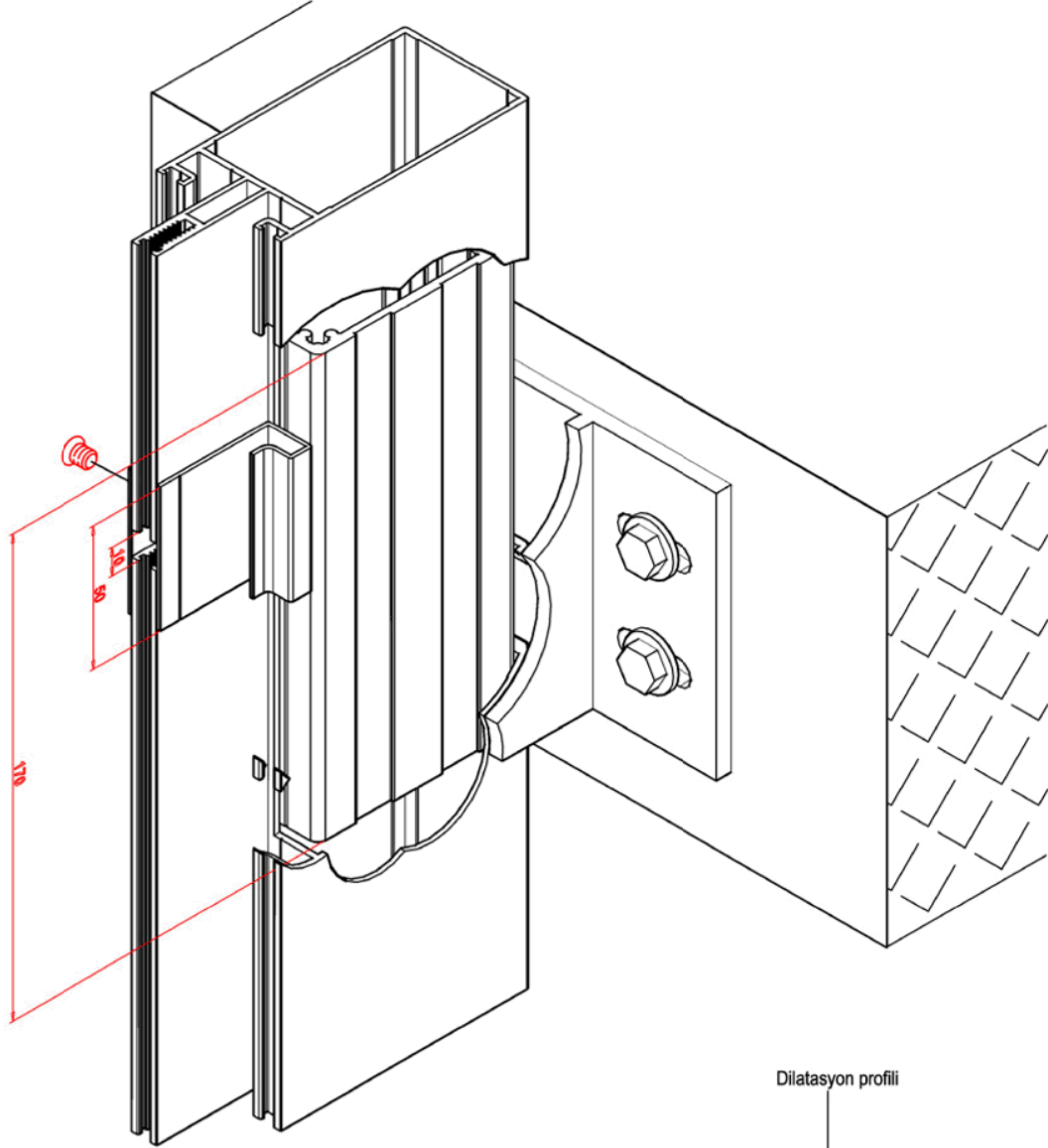

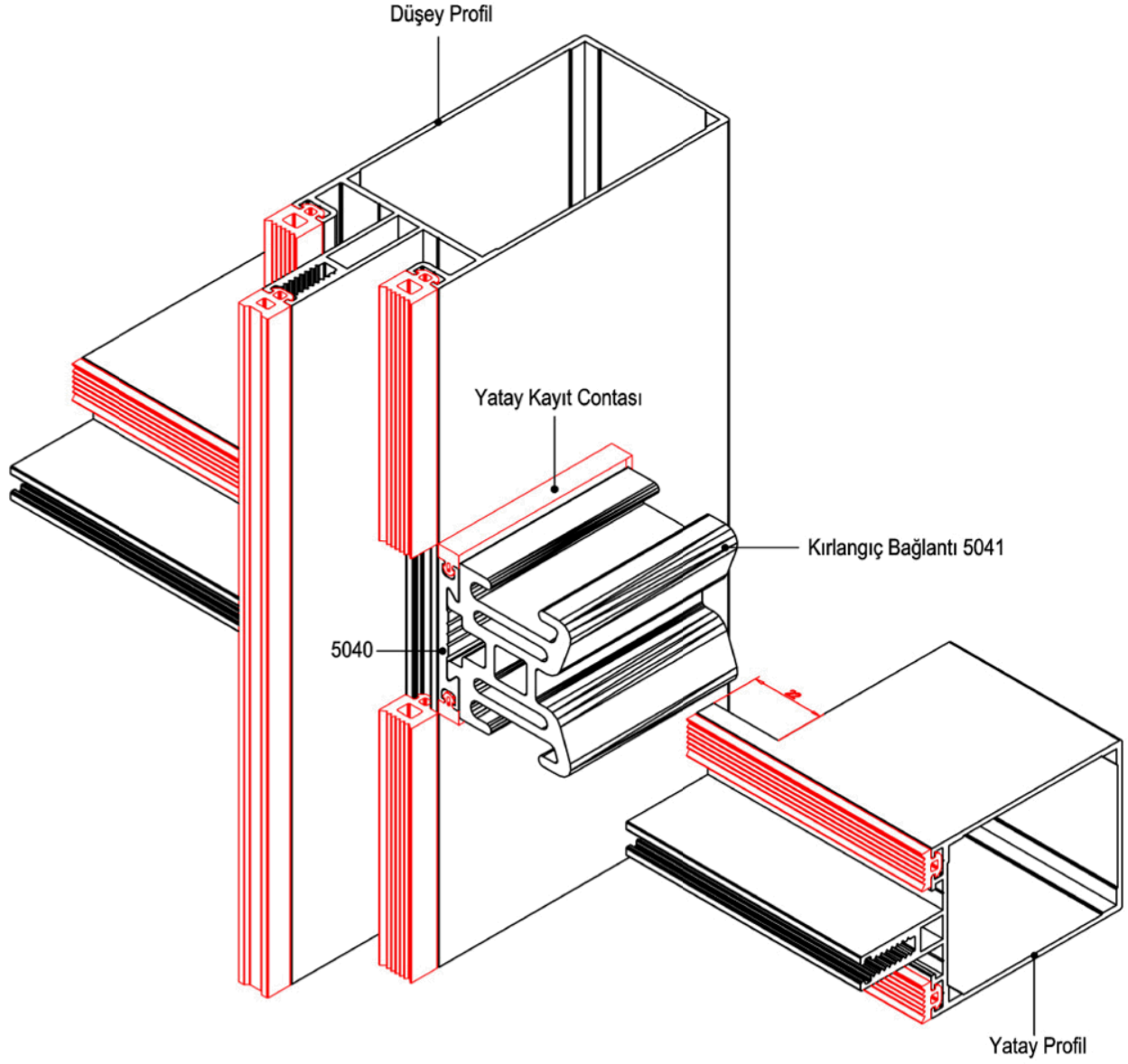

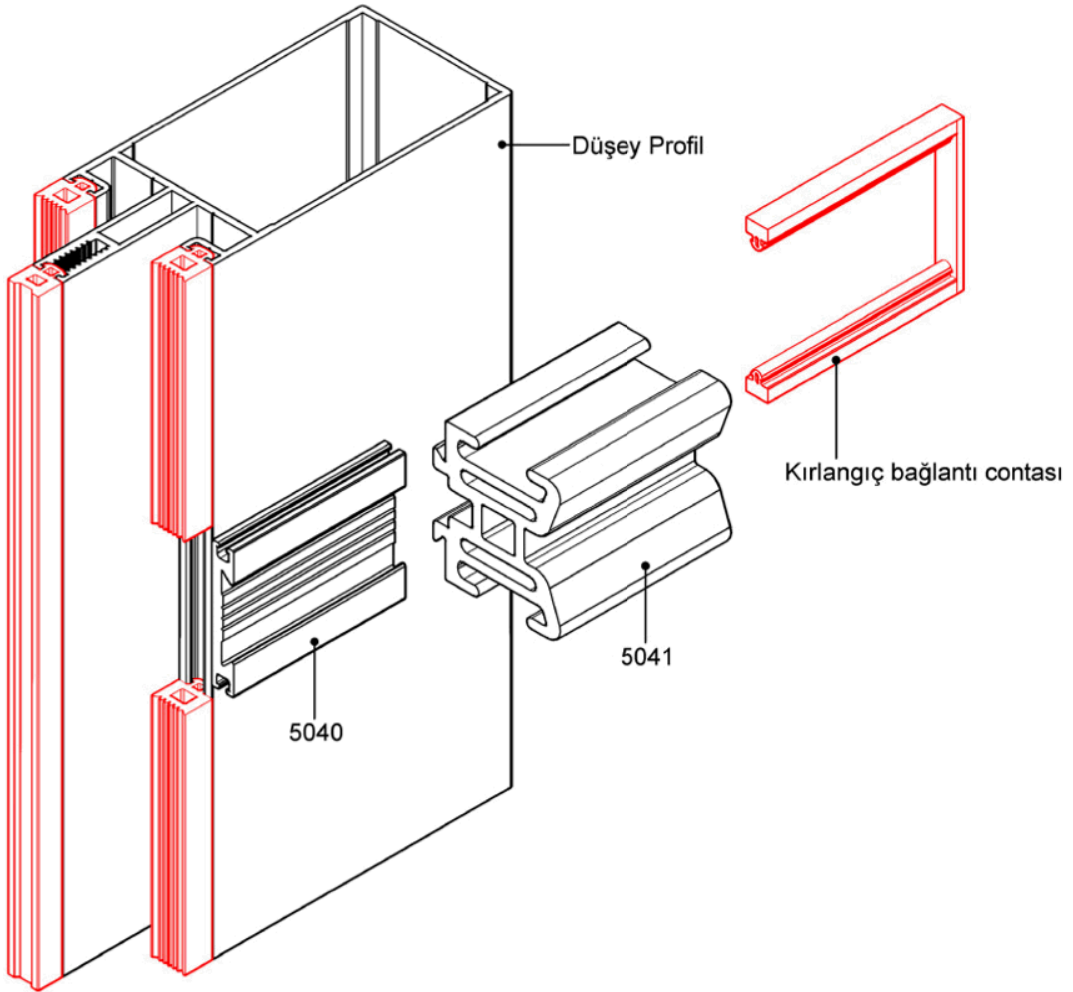



## KAPAKLI VE SİLİKON CEPHE SİSTEMİ DÜŞEY BAĞLANTI DETAYI

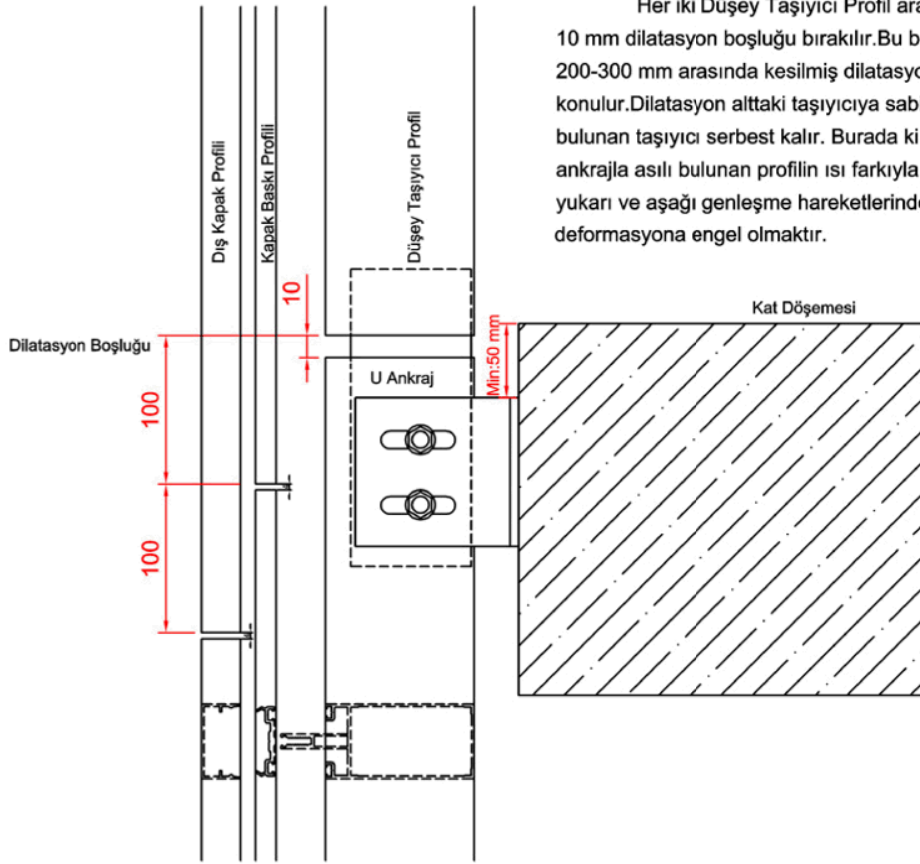

Her iki Düşey Taşıyıcı Profil arasında 10 mm dilatasyon boşluğu bırakılır. Bu boşluğa 200-300 mm arasında kesilmiş dilatasyon profili konulur. Dilatasyon alttaki taşıyıcıya sabitlenir üstte bulunan taşıyıcı serbest kalır. Burada ki amaç üstten ankrajla asılı bulunan profilin ısı farkıyla oluşan yukarı ve aşağı genişleme hareketlerinden dolayı deformasyona engel olmaktır.

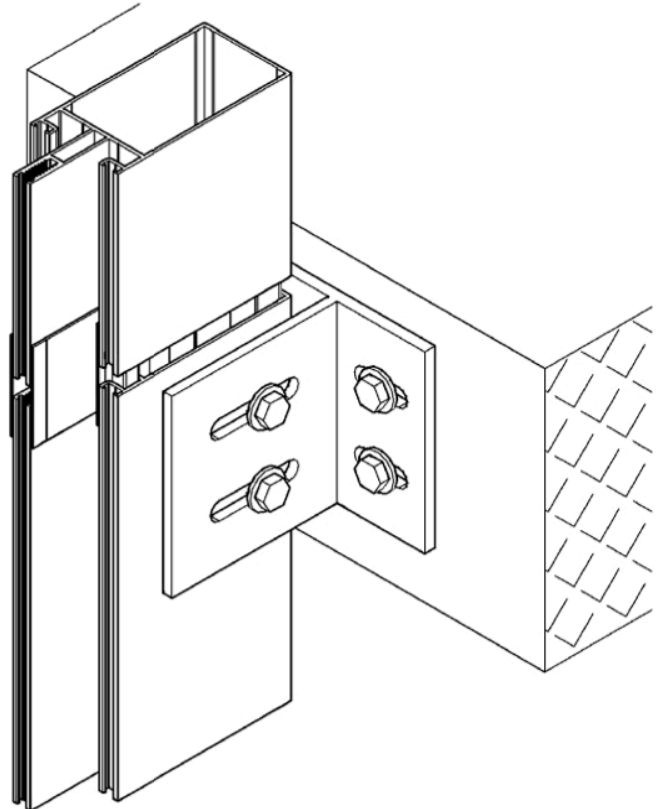
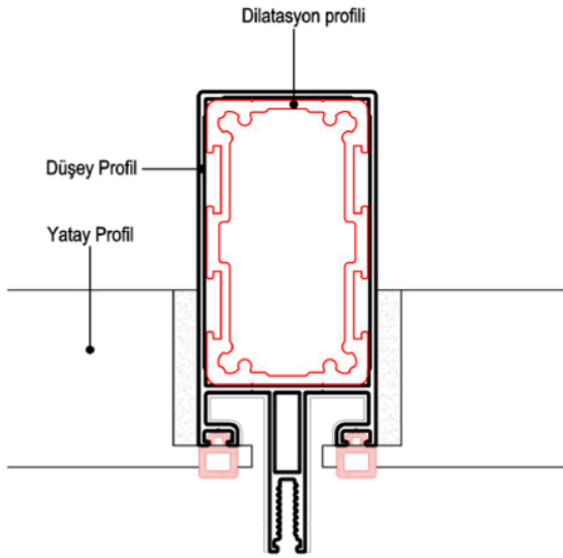



| KOD NO. | ŞEKİL | ADI                      | MALZEME |
|---------|-------|--------------------------|---------|
| CF 03   |       | Cam Fitili<br>3 mm       | EPDM    |
| CF 04   |       | Cam Fitili<br>4 mm       | EPDM    |
| CF 05   |       | Cam Fitili<br>5 mm       | EPDM    |
| CF 05 A |       | Kaset Cam Fitili<br>5 mm | EPDM    |
| CF 07   |       | Cam Fitili<br>7 mm       | EPDM    |
| CF 09   |       | Cam Fitili<br>9 mm       | EPDM    |
| CF 12   |       | Cam Fitili<br>12 mm      | EPDM    |
| MF 08   |       | Mesafe Fitili<br>8 mm    | EPDM    |



| KOD NO. | ŞEKİL | ADI                   | MALZEME |
|---------|-------|-----------------------|---------|
| YF 03   |       | Yastık Fitili<br>3 mm | EPDM    |
| YF 09   |       | Yastık Fitili<br>9 mm | EPDM    |
| KYF 10  |       | Kasa Yastık Fitili    | EPDM    |
| OYF 30  |       | Orta Yastık Fitili    | EPDM    |
| TF 20   |       | Tozluk Fitili         | EPDM    |
| KTF 20  |       | Kasa Tozluk Fitili    | EPDM    |
| KF 10   |       | Kapak Fitili          | EPDM    |
|         |       |                       |         |

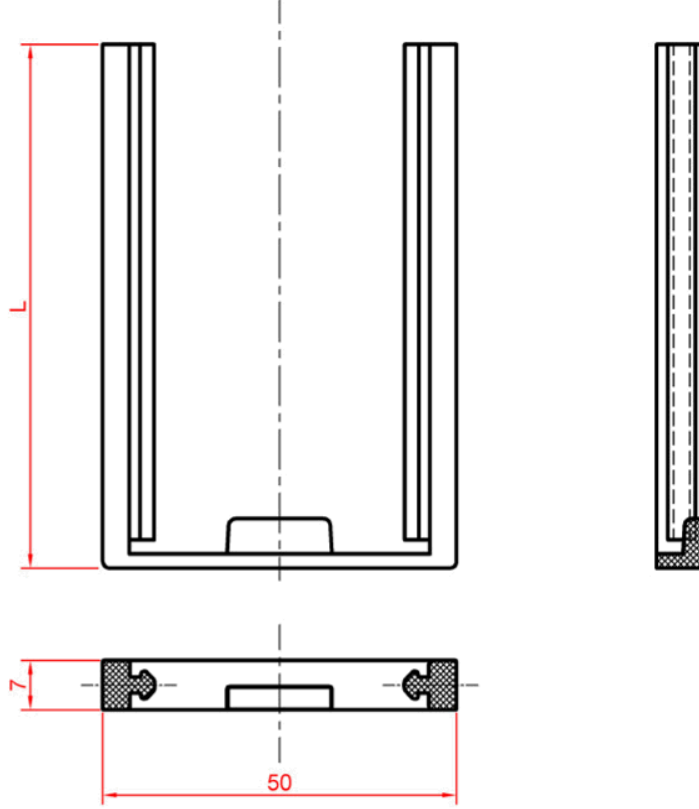

**KIRLANGIÇ GEÇME YAKALARI**

| KOD NO. | L  | KULLANILDIĞI PROFİL | MALZEME |
|---------|----|---------------------|---------|
| KG-1    | 74 | 5010                | EPDM    |
| KG-2    | 59 | 5011                | EPDM    |
| KG-3    | 44 | 5012                | EPDM    |

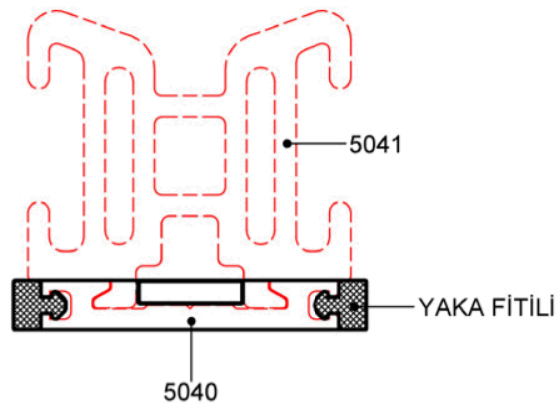



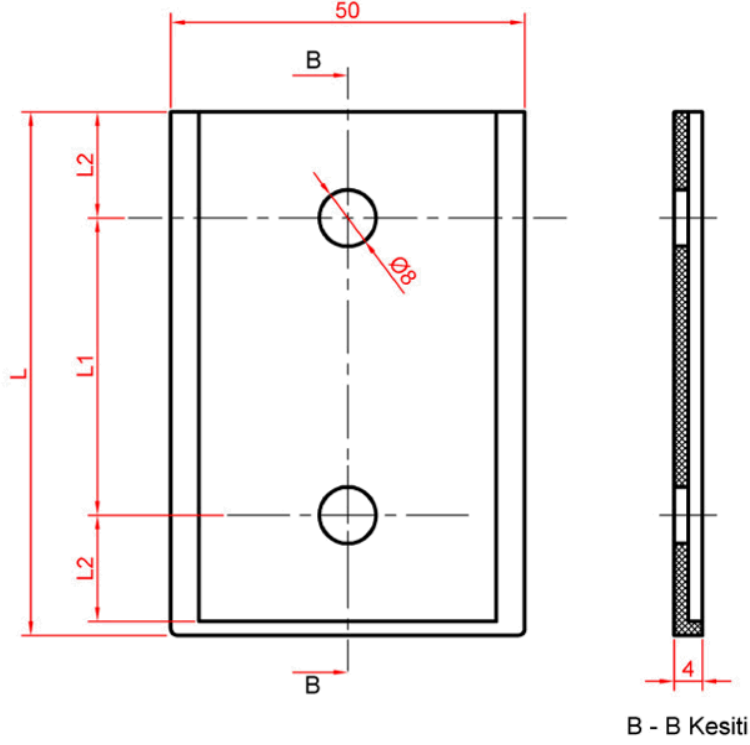

**DÜZ GEÇME YAKALARI**

| KOD NO. | L  | L1 | L2   | KULLANILDIĞI PROFİL | MALZEME |
|---------|----|----|------|---------------------|---------|
| DG-1    | 74 | 42 | 15   | 5010                | EPDM    |
| DG-2    | 59 | 32 | 12.5 | 5011                | EPDM    |
| DG-3    | 44 | 22 | 10   | 5012                | EPDM    |

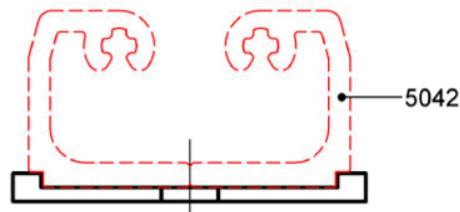



| AKSESUAR ADI                   | KOD NO.             | ŞEKİL |
|--------------------------------|---------------------|-------|
| CEPHE MAKASI                   | GSHD 10 700-1200    |       |
|                                | GSHD 12 800-1200    |       |
|                                | GSHD 14 1000-1300   |       |
|                                | GSHD 16 1200-1400   |       |
|                                | GSHD 18 1400-1400   |       |
|                                | GSHD 20 1600-1500   |       |
|                                | GSHD 22 1700-1500   |       |
|                                | GSHD 24 1800-1500   |       |
|                                | GSHD 28 2000-1500   |       |
| CEPHE KOLU<br>R29W ROTOLINE    | 01.020601 - Naturel |       |
| CEPHE KOLU<br>EURO GIESSE      | 01.100402 - Beyaz   |       |
|                                | 01.100405 - Siyah   |       |
|                                | 01.100409 - Gri     |       |
| İSPANYOLET KARŞILIĞI<br>AYARLI | 01.120200           |       |
| İSPANYOLET PİMİ                | 01.120102           |       |



| AKSESUAR ADI      | KOD NO.                | ŞEKİL |
|-------------------|------------------------|-------|
| U - ANKRAJ        | 80'lik<br>01.100121    |       |
|                   | 100'lük<br>01.100116   |       |
| L - ANKRAJ        | 80'lik<br>01.100106    |       |
|                   | 100'lük<br>01.100111   |       |
|                   | 120'lik<br>01.100113   |       |
| F - ANKRAJ        | 100'lük<br>01.100100   |       |
| BAĞLANTI CİVATASI | M10 x 100<br>01.100200 |       |
| ÇELİK DÜBEL       | M10 x 85<br>01.100204  |       |
|                   | M10 x 110<br>01.100208 |       |
|                   | M12 x 90<br>01.100212  |       |